

SEM-A

STANDART TİP SIKMALI EK MUFLAR

STANDARD TYPE BUTT CONNECTORS



*5846 sayılı yasa gereği fotoğrafların izinsiz yayınlanması ve kullanılması kesinlikle yasaktır.

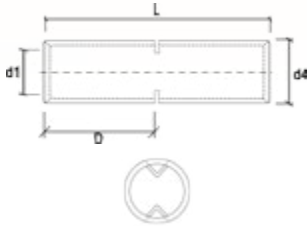

ÜRÜN KODU Order Code	KABLO KESİTİ Cable Section (mm ²)	BOYUTLAR Dimensions				KUTU ADEDİ Box Pcs.	KUTU AĞIRLIĞI Box Weight	KOLİ ADEDİ Parcel Pcs.	KOLİ AĞIRLIĞI Box Weight	BİRİM FİYATI Unit Price TL
		d1	d4	L	D					
SEM-A/006	6	4,0	5,5	25,0	12,5	800	~2,1 kg.	6.400	~16,8 kg	0,50
SEM-A/010	10	4,5	6,0	30,0	15,0	600	~2,1 kg.	4.800	~16,8 kg	0,55
SEM-A/016	16	5,5	7,5	35,0	17,5	300	~2,0 kg.	2.400	~16,0 kg	0,75
SEM-A/025	25	7,0	9,5	40,0	20,0	200	~2,4 kg.	1.600	~19,2 kg	1,30
SEM-A/035	35	8,5	11,0	45,0	22,5	150	~2,2 kg.	1.200	~17,6 kg	1,75
SEM-A/050	50	10,0	13,0	50,0	25,0	125	~3,0 kg.	1.000	~24,0 kg	3,00
SEM-A/070	70	11,5	14,5	55,0	27,5	80	~2,4 kg.	640	~19,2 kg	4,00
SEM-A/095	95	13,5	16,5	60,0	30,0	60	~2,3 kg.	480	~18,4 kg	4,15
SEM-A/120	120	14,5	18,0	65,0	32,5	40	~2,1 kg.	320	~16,8 kg	5,90
SEM-A/150	150	16,5	21,0	70,0	35,0	30	~2,6 kg.	240	~20,8 kg	9,40
SEM-A/185	185	18,5	23,0	75,0	37,5	20	~2,0 kg.	160	~16,0 kg	11,25
SEM-A/240	240	21,0	26,0	85,0	42,5	15	~2,1 kg.	120	~16,8 kg	15,50
SEM-A/300	300	23,5	28,5	100,0	50,0	10	~1,9 kg.	80	~15,2 kg	17,50
SEM-A/400	400	27,0	33,0	110,0	55,0	6	~1,5 kg.	48	~12,0 kg	30,00
SEM-A/500	500	30,0	38,0	120,0	60,0	4	~1,7 kg.	32	~13,6 kg	47,50
SEM-A/625	625	34,0	42,0	130,0	65,0	3	~1,7 kg.	24	~13,6 kg	75,00

SEM-A Özellikleri

Ham madde	: EN 13600 Bakır Boru
Material	: Electrolytic Copper Conformed To EN 13600
Kaplama	: Kalay
Coating	: Tin Plated
Bağlantı	: Sıkma + Lehim
Joint	: Clamp Coupling
Boru Et Kalınlığı	: Kalın
Thickness	: Thick

SEM-D

DIN 46267 TİP SIKMALI EK MUFLAR

DIN 46267 TYPE BUTT CONNECTORS



*5846 sayılı yasa gereği fotoğrafların izinsiz yayınlanması ve kullanılması kesinlikle yasaktır.

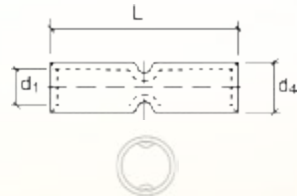

ÜRÜN KODU Order Code	KABLO KESİTİ Cable Section (mm ²)	BOYUTLAR Dimensions			KUTU ADEDİ Box Pcs.	KUTU AĞIRLIĞI Box Weight	KOLİ ADEDİ Parcel Pcs.	KOLİ AĞIRLIĞI Box Weight	BİRİM FİYATI Unit Price TL
		d1	d4	L					
SEM-D/006	6	3,8	5,5	30,0	700	~2,4 kg.	4200	~14,4 kg	0,50
SEM-D/010	10	4,5	6,0	30,0	600	~1,9 kg.	3600	~11,4 kg	0,55
SEM-D/016	16	5,5	8,5	50,0	200	~2,9 kg.	1200	~17,4 kg	1,60
SEM-D/025	25	7,0	10,0	50,0	150	~2,7 kg.	900	~16,2 kg	2,00
SEM-D/035	35	8,2	12,5	50,0	125	~3,9 kg.	750	~23,4 kg	3,50
SEM-D/050	50	10,0	14,5	56,0	80	~3,4 kg.	480	~20,4 kg	5,00
SEM-D/070	70	11,5	16,5	56,0	50	~2,7 kg.	300	~16,2 kg	6,00
SEM-D/095	95	13,5	19,0	70,0	35	~3,1 kg.	210	~18,6 kg	8,60
SEM-D/120	120	15,5	21,0	70,0	25	~2,4 kg.	150	~14,4 kg	9,20
SEM-D/150	150	17,0	23,5	80,0	20	~2,9 kg.	120	~17,4 kg	13,50
SEM-D/185	185	19,0	25,5	85,0	12	~2,1 kg.	72	~12,6 kg	16,00
SEM-D/240	240	21,5	29,0	90,0	10	~2,4 kg.	60	~14,4 kg	22,00
SEM-D/300	300	24,5	32,0	100,0	8	~2,4 kg.	48	~14,4 kg	29,00
SEM-D/400	400	27,5	38,5	150,0	4	~3,0 kg.	24	~18,0 kg	67,00
SEM-D/500	500	31,0	42,0	160,0	2	~1,8 kg.	12	~10,8 kg	80,00
SEM-D/625	625	34,5	44,0	160,0	3	~1,6 kg.	18	~9,6 kg	85,00
SEM-D/800	800	40,0	52,0	200,0	1	~1,5 kg.	6		
SEM-D/1000	1000	44,0	58,0	200,0	1	~2,0 kg.	6		

SEM-D Özellikleri

Ham madde	: EN 13600 Bakır Boru
Material	: Electrolytic Copper Conformed To EN 13600
Kaplama	: Kalay
Coating	: Tin Plated
Bağlantı	: Sıkma
Joint	: Clamp Coupling
DIN Normu 46267'ye uygundur	
Conformed to DIN 46167	