

# SKP-S3

## SIKMALI KABLO PABUCU LONGER BARREL TUBULAR CABLE LUGS

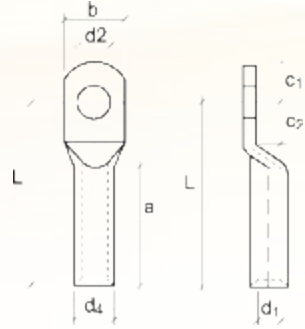

\*5846 sayılı yasa gereği fotoğrafların izinsiz yayınlanması ve kullanılması kesinlikle yasaktır.



ÜRÜN KODU Order Code	KABLO KESİTİ Cable Section (mm <sup>2</sup> )	CIVATA DELİĞİ Bolt	BOYUTLAR Dimensions								KUTU ADEĐİ Box Pcs.	KUTU AĞIRLIĞI Box Weight	KOLİ ADEĐİ Parcel Pcs.	KOLİ AĞIRLIĞI Box Weight	BİRİM FİYATI Unit Price TL
			d1	d4	a	d2	b	c1	c2	L					
SKP-S3/025-M05	25	M5	7,0	10,0	40,0	5,5	14,0	7,5	7,5	55,0	125	~2,7 kg.	750	16,2 kg	3,00
SKP-S3/025-M06		M6	7,0	10,0	40,0	6,5	14,0	7,5	7,5	55,0	125	~2,6 kg.	750	15,6 kg	3,00
SKP-S3/025-M08/SD		M8	7,0	10,0	40,0	8,4	16,0	10,0	10,0	57,0	125	~2,8 kg.	750	16,8 kg	3,00
SKP-S3/025-M10		M10	7,0	10,0	40,0	10,5	18,0	12,0	12,0	59,0	125	~2,9 kg.	750	17,4 kg	3,25
SKP-S3/025-M12		M12	7,0	10,0	40,0	13,0	19,0	13,0	13,0	60,0	125	~2,9 kg.	750	17,4 kg	4,00
SKP-S3/025-M14		M14	7,0	10,0	40,0	15,0	21,0	14,5	14,5	63,0	125	~3,0 kg.	750	18,0 kg	4,75
SKP-S3/035-M06	35	M6	8,5	12,0	40,0	6,5	17,0	7,5	7,5	55,0	80	~2,4 kg.	480	14,4 kg	5,00
SKP-S3/035-M08/SD		M8	8,5	12,0	40,0	8,4	17,0	10,0	10,0	57,0	80	~2,4 kg.	480	14,4 kg	5,00
SKP-S3/035-M10		M10	8,5	12,0	40,0	10,5	19,0	12,0	12,0	60,0	80	~2,7 kg.	480	16,2 kg	5,25
SKP-S3/035-M12		M12	8,5	12,0	40,0	13,0	21,0	13,0	13,0	61,0	80	~2,7 kg.	480	16,2 kg	5,50
SKP-S3/035-M14		M14	8,5	12,0	40,0	15,0	21,0	14,5	14,5	63,0	80	~2,7 kg.	480	16,2 kg	6,25
SKP-S3/035-M16		M16	8,5	12,0	40,0	17,0	26,0	16,0	16,0	65,0	80	~2,8 kg.	480	16,8 kg	7,00
SKP-S3/050-M06	50	M6	10,0	14,0	50,0	6,5	20,0	10,0	10,0	68,0	50	~2,6 kg.	300	15,6 kg	8,00
SKP-S3/050-M08		M8	10,0	14,0	50,0	8,5	20,0	10,0	10,0	68,0	50	~2,5 kg.	300	15,0 kg	8,00
SKP-S3/050-M10/SD		M10	10,0	14,0	50,0	10,5	20,0	12,0	12,0	70,0	50	~2,6 kg.	300	15,6 kg	8,00
SKP-S3/050-M12		M12	10,0	14,0	50,0	13,0	23,0	13,0	13,0	74,0	50	~2,7 kg.	300	16,2 kg	8,50
SKP-S3/050-M14		M14	10,0	14,0	50,0	15,0	23,0	14,5	14,5	76,0	50	~2,7 kg.	300	16,2 kg	9,00
SKP-S3/050-M16		M16	10,0	14,0	50,0	17,0	28,0	16,0	16,0	77,0	50	~2,8 kg.	300	16,8 kg	9,50
SKP-S3/050-M20	M20	10,0	14,0	50,0	21,0	30,0	19,0	19,0	79,0	50	~2,8 kg.	300	16,8 kg	10,50	
SKP-S3/070-M06	70	M6	12,0	16,5	50,0	6,5	23,0	10,0	10,0	72,0	40	~2,9 kg.	240	17,4 kg	9,00
SKP-S3/070-M08		M8	12,0	16,5	50,0	8,5	23,0	10,0	10,0	72,0	40	~2,9 kg.	240	17,4 kg	9,00
SKP-S3/070-M10/SD		M10	12,0	16,5	50,0	10,5	23,0	12,0	12,0	73,0	40	~2,9 kg.	240	17,4 kg	9,00
SKP-S3/070-M12		M12	12,0	16,5	50,0	13,0	23,0	13,0	13,0	75,0	40	~3,0 kg.	240	18,0 kg	9,00
SKP-S3/070-M14		M14	12,0	16,5	50,0	15,0	23,0	14,5	14,5	77,0	40	~3,0 kg.	240	18,0 kg	9,50
SKP-S3/070-M16		M16	12,0	16,5	50,0	17,0	28,0	16,0	16,0	79,0	40	~3,1 kg.	240	18,6 kg	10,00
SKP-S3/070-M20	M20	12,0	16,5	50,0	21,0	30,0	19,0	19,0	82,0	40	~3,1 kg.	240	18,6 kg	10,50	
SKP-S3/095-M08	95	M8	13,5	18,0	50,0	8,5	26,0	12,0	12,0	73,0	30	~2,5 kg.	180	15,0 kg	11,00
SKP-S3/095-M10		M10	13,5	18,0	50,0	10,5	26,0	12,0	12,0	73,0	30	~2,5 kg.	180	15,0 kg	11,00
SKP-S3/095-M12/SD		M12	13,5	18,0	50,0	13,0	26,0	13,0	13,0	74,0	30	~2,5 kg.	180	15,0 kg	11,00
SKP-S3/095-M14		M14	13,5	18,0	50,0	15,0	26,0	14,5	14,5	76,0	30	~2,6 kg.	180	15,6 kg	11,50
SKP-S3/095-M16		M16	13,5	18,0	50,0	17,0	28,0	16,0	16,0	79,0	30	~2,7 kg.	180	16,2 kg	12,00
SKP-S3/095-M20		M20	13,5	18,0	50,0	21,0	36,0	22,0	22,0	85,0	30	~2,8 kg.	180	16,8 kg	13,00

ÜRÜN KODU Order Code	KABLO KESİTİ Cable Section (mm <sup>2</sup> )	CIVATA DELİĞİ Bolt	BOYUTLAR Dimensions								KUTU ADEĐİ Box Pcs.	KUTU AĞIRLIĞI Box Weight	KOLİ ADEĐİ Parcel Pcs.	KOLİ AĞIRLIĞI Box Weight	BİRİM FİYATI Unit Price TL
			d1	d4	a	d2	b	c1	c2	L					
SKP-S3/120-M08	120	M8	15,0	19,5	60,0	8,5	28,0	14,0	14,0	85,0	25	~2,6 kg.	150	15,6 kg	12,25
SKP-S3/120-M10		M10	15,0	19,5	60,0	10,5	28,0	14,0	14,0	85,0	25	~2,6 kg.	150	15,6 kg	12,25
SKP-S3/120-M12/SD		M12	15,0	19,5	60,0	13,0	28,0	14,0	14,0	85,0	25	~2,6 kg.	150	15,6 kg	12,25
SKP-S3/120-M14		M14	15,0	19,5	60,0	15,0	28,0	15,0	15,0	86,0	25	~2,6 kg.	150	15,6 kg	13,00
SKP-S3/120-M16		M16	15,0	19,5	60,0	17,0	30,0	16,0	16,0	88,0	25	~2,7 kg.	150	16,2 kg	13,50
SKP-S3/120-M20		M20	15,0	19,5	60,0	21,0	36,0	22,0	22,0	97,0	25	~2,9 kg.	150	17,4 kg	14,50
SKP-S3/150-M08	150	M8	16,5	21,0	60,0	8,5	31,0	14,0	14,0	86,0	20	~2,3 kg.	120	13,8 kg	13,75
SKP-S3/150-M10		M10	16,5	21,0	60,0	10,5	31,0	14,0	14,0	86,0	20	~2,3 kg.	120	13,8 kg	13,75
SKP-S3/150-M12/SD		M12	16,5	21,0	60,0	13,0	31,0	15,0	15,0	87,0	20	~2,3 kg.	120	13,8 kg	13,75
SKP-S3/150-M14		M14	16,5	21,0	60,0	15,0	31,0	15,0	15,0	87,0	20	~2,3 kg.	120	13,8 kg	14,25
SKP-S3/150-M16		M16	16,5	21,0	60,0	17,0	31,0	16,0	16,0	88,0	20	~2,3 kg.	120	13,8 kg	14,75
SKP-S3/150-M20		M20	16,5	21,0	60,0	21,0	36,0	22,0	22,0	96,0	20	~2,5 kg.	120	15,0 kg	15,75
SKP-S3/185-M10	185	M10	19,0	24,0	60,0	10,5	35,0	16,0	16,0	92,0	12	~2,0 kg.	72	12,0 kg	18,50
SKP-S3/185-M12/SD		M12	19,0	24,0	60,0	13,0	35,0	16,0	16,0	92,0	12	~2,0 kg.	72	12,0 kg	18,50
SKP-S3/185-M14		M14	19,0	24,0	60,0	15,0	35,0	16,0	16,0	92,0	12	~2,0 kg.	72	12,0 kg	18,50
SKP-S3/185-M16		M16	19,0	24,0	60,0	17,0	35,0	16,0	16,0	92,0	12	~1,9 kg.	72	11,4 kg	18,50
SKP-S3/185-M20		M20	19,0	24,0	60,0	21,0	39,0	21,5	19,0	96,0	12	~2,0 kg.	72	12,0 kg	19,50
SKP-S3/240-M10	240	M10	21,0	26,0	60,0	10,5	39,0	16,5	16,5	94,0	12	~2,3 kg.	72	13,8 kg	20,00
SKP-S3/240-M12/SD		M12	21,0	26,0	60,0	13,0	39,0	16,5	16,5	94,0	12	~2,2 kg.	72	13,2 kg	20,00
SKP-S3/240-M14		M14	21,0	26,0	60,0	15,0	39,0	16,5	16,5	94,0	12	~2,1 kg.	72	12,6 kg	20,00
SKP-S3/240-M16		M16	21,0	26,0	60,0	17,0	39,0	16,5	16,5	94,0	12	~2,1 kg.	72	12,6 kg	20,00
SKP-S3/240-M20		M20	21,0	26,0	60,0	21,0	39,0	21,5	19,0	97,0	12	~2,2 kg.	72	13,2 kg	21,00

### SKP-S3 Özellikleri

Hammadde	: EN 13600 Bakır Boru
Material	: Electrolytic Copper Conformed To EN 13600
Kaplama	: Kalay
Coating	: Tin Plated
Bağlantı	: Sıkma
Joint	: Clamp Coupling
Boru Et Kalınlığı	: Çok Kalın
Thickness	: Very Thick
Kablo Girişi	: Çok Uzun
Cable Entry	: Very Long



Bu tabloda koyu yazı karakteri ile belirtilmiş olan kablo pabuçları standart üretimimizdir.

The cable lugs which are indicated in bolt font, are standart products of **Simpa**